



## 39 Rose Street Rochester, Kent, ME1 2EE

Greenleaf are delighted to offer this charming two bedroom terraced house to let in Rochester. Just a short distance walk into the Historic High Street and to Rochester Railway Station. Just redecorated and new carpets throughout. Offering two reception rooms, kitchen with integrated oven and hob, utility room, two double bedrooms and family bathroom. Rear garden, on street parking and gas central heating. Available now. Call to arrange viewings.

In order to reserve a property you will be required to pay a holding deposit equivalent to one weeks rent. This will be refunded once checks are complete unless false or misleading information is provided, a Right to Rent check fails or you withdraw from the property. It can, with agreement be put towards the first months rent due along with the five week deposit. If you require any further information just give the team a call or email on [info@greenleaf-property.co.uk](mailto:info@greenleaf-property.co.uk).

Greenleaf are a member of the PRS (property redress scheme) membership number: PRS003992  
Greenleaf Property Services Ltd have client money protection – property mark - membership – C0128543

## £1,250 Per Month

# 39 Rose Street

Rochester, Kent, ME1 2EE



- TWO BEDROOM TERRACED HOUSE
- EASY TO MAINTAIN REAR GARDEN
- COUNCIL TAX BAND B
- WITHIN EASY REACH OF HISTORIC HIGH ST AND RAILWAY STATION
- HOLDING DEPOSIT £288.46
- JUST REDECORATED, NEW CARPETS
- TWO RECEPTION ROOMS
- 5 WEEK DEPOSIT £1442.30
- AVAILABLE NOW



[Directions](#)

Tel: 01634730672







GROUND FLOOR  
406 sq.ft. (37.6 sq.m.) approx.

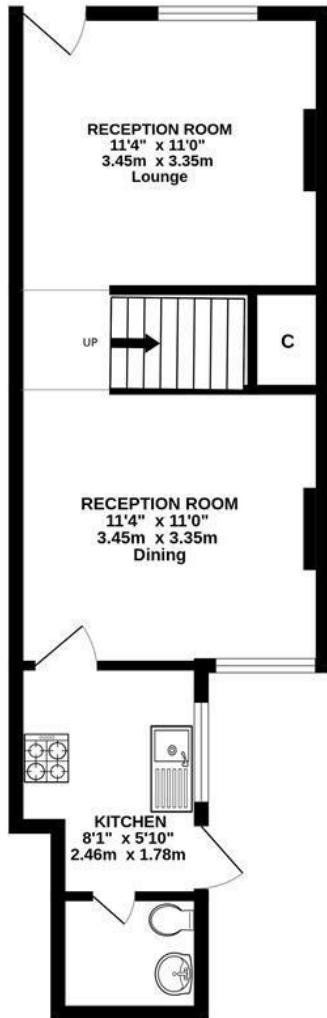

1ST FLOOR  
386 sq.ft. (35.9 sq.m.) approx.

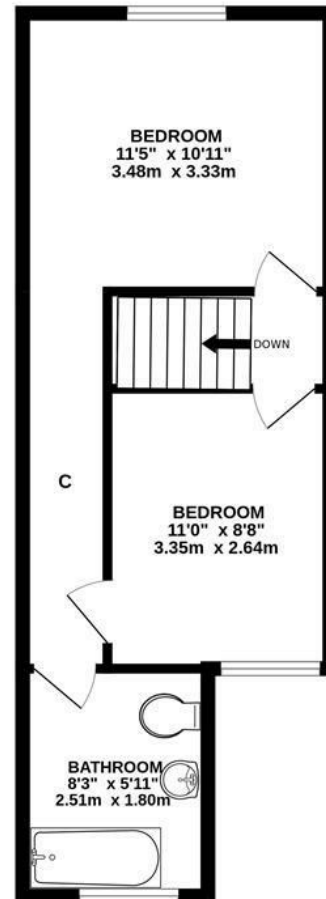

TOTAL FLOOR AREA: 791 sq.ft. (73.5 sq.m.) approx.

Whilst every attempt has been made to ensure the accuracy of the floorplan contained here, measurements of doors, windows, rooms and any other items are approximate and no responsibility is taken for any error, omission or mis-statement. This plan is for illustrative purposes only and should be used as such by any prospective purchaser. The services, systems and appliances shown have not been tested and no guarantee as to their operability or efficiency can be given.  
Made with Metropix ©2026

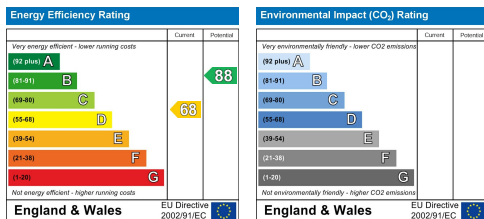

Greenleaf Property Services is a trading name of Greenleaf Property Services Limited.  
Registered Office: 281 Wilson Avenue, Rochester Kent ME1 2SS  
Registered No: 06222461 England. VAT No: 908929091

These particulars, whilst believed to be accurate are set out as a general outline only for guidance and do not constitute any part of an offer or contract. Intending purchasers should not rely on them as statements of representation of fact, but must satisfy themselves by inspection or otherwise as to their accuracy. No person in this firm's employment has the authority to make or give any representation or warranty in respect of the property.